

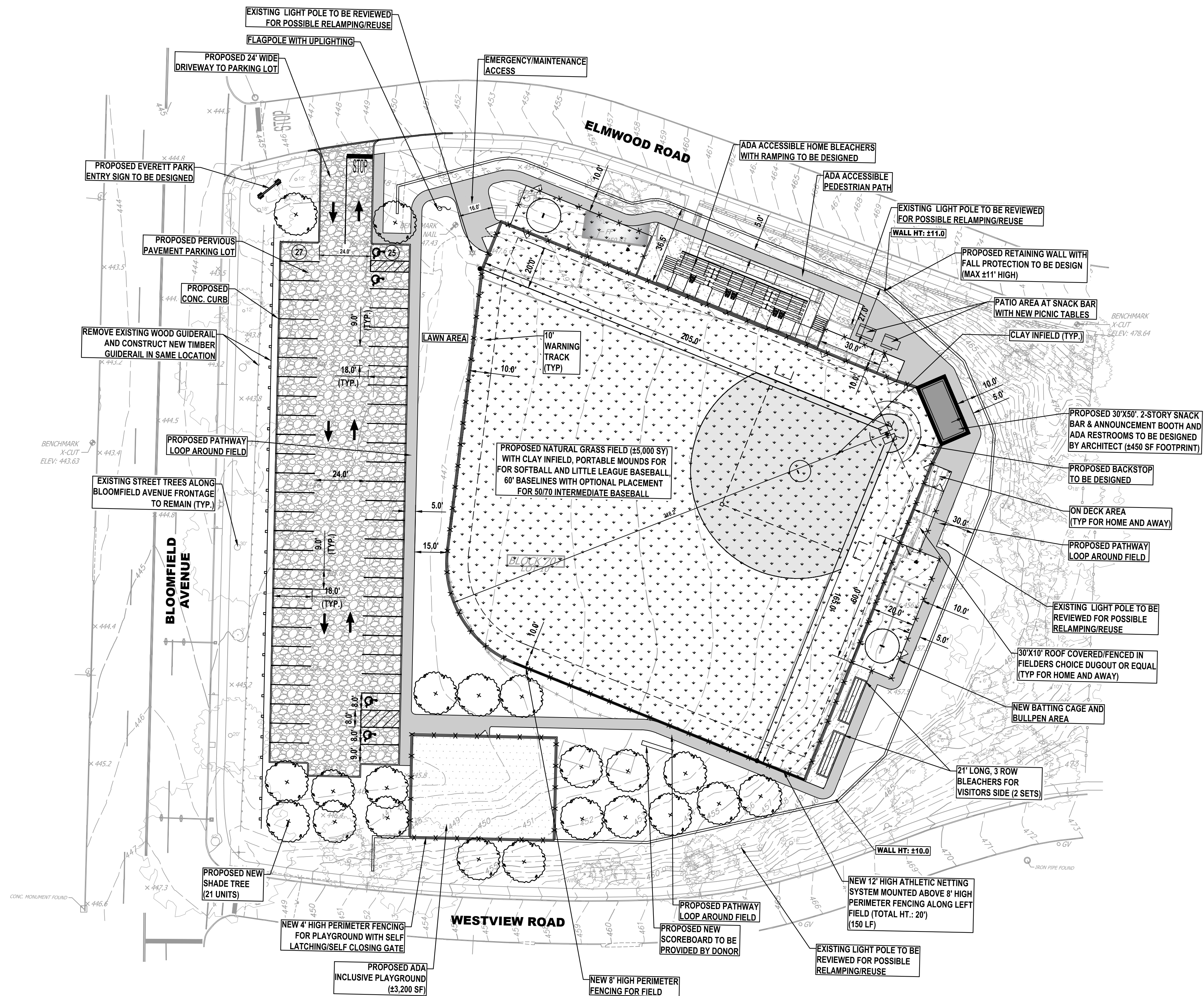

N.J.P.C.S.

GRAPHIC SCALE

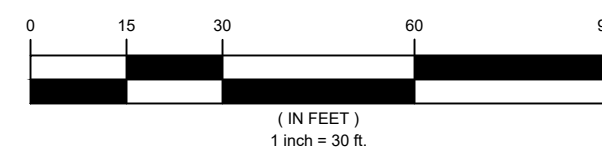

SITE PLAN LEGEND	
	PLAYGROUND AREA
	POROUS PAVEMENT
	GRASS FIELD
	6" THICK CONCRETE SIDEWALK
	ASPHALT WALKWAY

GENERAL NOTES:

- EXISTING CONDITIONS AS PER PLAN ENTITLED, "TOPOGRAPHIC SURVEY, EVERETT PARK, BLOCK 707 LOT 10, TOWNSHIP OF VERONA, ESSEX COUNTY, NEW JERSEY," PREPARED BY NEGLIA ENGINEERING ASSOCIATES, DATED JUNE 6, 2023.
- CONCEPT PLAN FOR PLANNING PURPOSES ONLY AND NOT FOR CONSTRUCTION.

CAUTION: IF THIS DOCUMENT DOES NOT CONTAIN THE RAISED IMPRESSION SEAL OF THE PROFESSIONAL, IT IS NOT AN AUTHORIZED ORIGINAL DOCUMENT AND MAY HAVE BEEN ALTERED. © COPYRIGHT 2022 BY NEGLIA ENGINEERING. ALL RIGHTS RESERVED.

CERTIFICATE OF AUTHORIZATION (N.J.S.A. 45:8-56) 24GA27927000

REVISIONS			DRAWN	DESIGNED	CHECKED
NO.	DATE	DESCRIPTION			

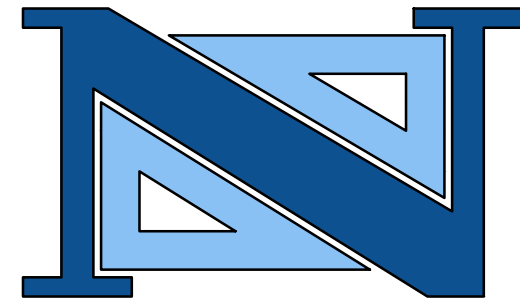

ANTHONY KURUS, P.E., P.P.

PROFESSIONAL ENGINEER
N.J. LICENSE NO. 46445

PROFESSIONAL PLANNER
N.J. LICENSE NO. 6145

NEGLIA ENGINEERING ASSOCIATES

34 PARK AVENUE
TEL: 201-939-8805

LYNDHURST
NEW JERSEY
FAX: 201-939-0846

E-MAIL: NEA@NEGLIAENGINEERING.COM

MICHAEL J. NEGLIA, P.E., P.L.S., P.P.

PROFESSIONAL ENGINEER
N.J. LICENSE NO. 38604

PROFESSIONAL LAND SURVEYOR
N.J. LICENSE NO. 38604

PROFESSIONAL PLANNER
N.J. LICENSE NO. 33L00569800

**CONCEPT SITE PLAN
EVERETT PARK SITE IMPROVEMENTS
BLOCK 707 LOT 10
TOWNSHIP OF VERONA
ESSEX COUNTY
NEW JERSEY**

DRAWN BY: M.F.L.	CHECKED BY: A.K.	PROJECT NO:	SHEET NO:
DESIGNED BY: M.F.L.	SCALE: 1" = 30'	VEROMUN23.010	CP-1
FIELD BOOK NO:	PAGE:	DATE: JANUARY 30, 2024	

m:\veronamun23.010\everett_park\site_plan.dwg (242x30) Date Plotted: Tuesday, January 30, 2024 3:17:55 PM



N.J.P.C.S.

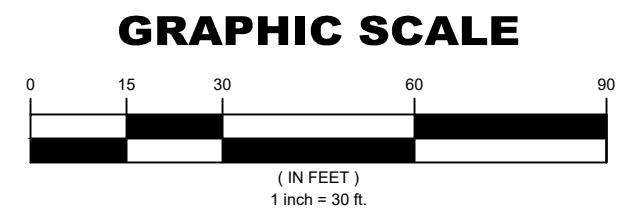

TREE REMOVAL SUMMARY

15 TREE REMOVALS OF 6" DPM BUT LESS THAN 16"	15 TREE REPLACEMENTS REQ.
1 TREE REMOVAL OF 16" BUT LESS THAN 24" TREE REMOVAL	2 TREE REPLACEMENTS REQ.
1 TREE REMOVAL OF 24" OR GREATER TREE REMOVAL	4 TREE REPLACEMENTS REQ.
TOTAL OF 21 TREE REPLACEMENTS REQ.	
THE PROJECT PROPOSES 21 NEW SHADE TREES AS SHOWN ON THE PLANS.	

STEEP SLOPE DISTURBANCE CALCULATION

TOTAL AREA OF PROJECT SITE	125,888 S.F. (2.89 ACRES)	
NONREGULATED SLOPE (0%-14.9%)	78,860 S.F. (1.81 ACRES)	89.2% OF STEEP SLOPE DIST.
PRECAUTIONARY SLOPE (15% - 24.9%)	5,140 S.F. (0.12 ACRES)	5.8% OF STEEP SLOPE DIST.
PROHIBITIVE SLOPES (25% OR GREATER)	4,433 S.F. (0.10 ACRES)	5% OF STEEP SLOPE DIST.

GENERAL NOTES:
 1. EXISTING CONDITIONS AS PER PLAN ENTITLED, "TOPOGRAPHIC SURVEY, EVERETT PARK, BLOCK 707 LOT 10, TOWNSHIP OF VERONA, ESSEX COUNTY, NEW JERSEY," PREPARED BY NEGLIA ENGINEERING ASSOCIATES, DATED JUNE 6, 2023.
 2. CONCEPT PLAN FOR PLANNING PURPOSES ONLY AND NOT FOR CONSTRUCTION.

CAUTION: IF THIS DOCUMENT DOES NOT CONTAIN THE RAISED IMPRESSION SEAL OF THE PROFESSIONAL, IT IS NOT AN AUTHORIZED ORIGINAL DOCUMENT AND MAY HAVE BEEN ALTERED. © COPYRIGHT 2022 BY NEGLIA ENGINEERING. ALL RIGHTS RESERVED.

CERTIFICATE OF AUTHORIZATION (N.J.S.A. 45:8-56) 24GA27927000

REVISIONS		DRAWN	DESIGNED	CHECKED
NO.	DATE			

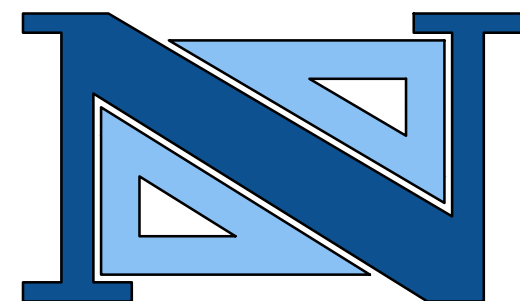

ANTHONY KURUS, P.E., P.P.

PROFESSIONAL ENGINEER
N.J. LICENSE NO. 46445

PROFESSIONAL PLANNER
N.J. LICENSE NO. 6145

A PROJECT OF
NEGLIA ENGINEERING ASSOCIATES
 34 PARK AVENUE
 TEL: 201-939-8805
 LYNDHURST NEW JERSEY
 FAX: 201-939-0846
 E-MAIL: NEA@NEGLIAENGINEERING.COM

MICHAEL J. NEGLIA, P.E., P.L.S., P.P.
 PROFESSIONAL ENGINEER
N.J. LICENSE NO. 38604

PROFESSIONAL LAND SURVEYOR
N.J. LICENSE NO. 38604

PROFESSIONAL PLANNER
N.J. LICENSE NO. 33100569800

**TREE REMOVAL AND STEEP SLOPE ANALYSIS
 EVERETT PARK SITE IMPROVEMENTS
 BLOCK 707 LOT 10
 TOWNSHIP OF VERONA
 ESSEX COUNTY NEW JERSEY**

DRAWN BY: M.F.L.	CHECKED BY: A.K.	PROJECT NO: VEROMUN23.010	SHEET NO: CP-2
DESIGNED BY: M.F.L.	SCALE: 1" = 30'	DATE: JANUARY 30, 2023	
FIELD BOOK NO:	PAGE:		

m:\veronamun23.010\everett_park\sheet_010.dwg (242x30) Date: 1/30/2023 3:48:30 PM