

REVISIONS				
DATE	BY	LIC.NO	BLOCK	LOT
12/2019	ED CLAY	34842	2105	18-19
09/2020	ED CLAY	34842	2106	3

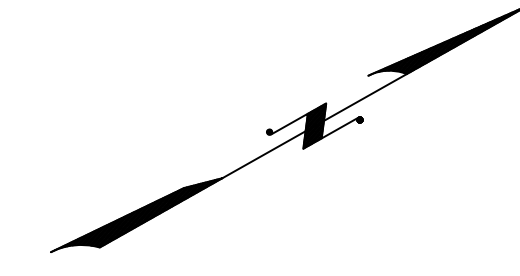

PROJECT SITE
21 HOWARD STREET

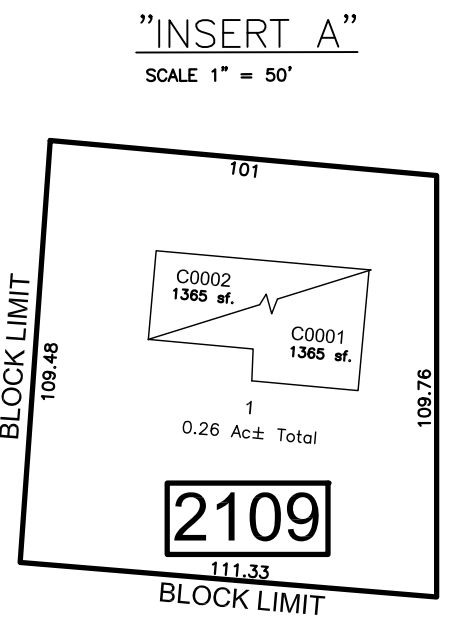

103 PEASE AVENUE
Unit No. 1 - C0001
Unit No. 2 - C0002

P.L.S.	LIC.	DATE	REVISION
JMH	24272	1-1-2013	NEW BLOCK NUMBERS
JMH	24272	12/15/88	BLOCK 108--LOT 11 REVISED HOUSE NUM.
JMH	24272	11/4/88	BLOCK 111--LOT 15, NEW LOT 15.01
			BLOCK 112--LOT 18 REVISED
			BLOCK 112--LOT 55 REVISED
			BLOCK 109--LOT 14 REVISED

SHEET 19

SHEET 18

SHEET 22

SHEET 16

THIS MAP HAS BEEN GIVEN A FORMAL CERTIFICATION BY THE DIVISION OF TAXATION ON NOVEMBER 27, 2015, SIGNED BY JUDY P. MILLER AND TIFFANY A. FIELDS ASSIGNED SERIAL NUMBER 1067

TAX MAP
TOWNSHIP OF VERONA
ESSEX COUNTY, NEW JERSEY
SCALE: 1" = 100'
JANUARY 1, 2017
PREPARED BY
JAMES M. HELB, P.E., P.L.S., P.P.
NEW JERSEY LICENSE NO. 24272
TOWNSHIP ENGINEER
10 COMMERCE COURT
VERONA, NJ 07044
TO SHOW CONDITIONS AS OF DECEMBER 2019

THIS IS A DIGITIZED COPY OF THE TAX MAP PREPARED BY CASEY & KELLER, INC AND DATED JAN. 1, 1983. THE APPROVED ORIGINAL IS ON FILED IN THE OFFICE OF THE ENGINEER.